



### CONTROL POINT DETAILS

Station Number: **PSM 5511**

### Coordinate Information

Geodetic	Grid
WGS 84	UTM Zone 43
Lat: 2° 55' 7.1"	E: 264638.095m
Long: 72° 52' 57.4"	N: 322820.707m
Ellp Height: -91.647m	Orth Height: 0.474m
<b>Island Name: Dhoores</b>	<b>Date: 20 June 2012</b>

### Monument description & method of survey:

Monument Type A. Point fixed using closed-traverse technique of surveying.  
Static GPS surveying technique is used to give geo-referencing.  
Final coordinates derived after traverse adjustment.

### General site conditions & access:

Point located in open space. Low vegetation in proximity. Easily accessible.

Owner: Vermillion International Pvt. Ltd.

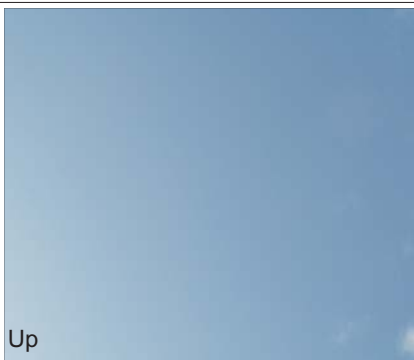

# SITE INFORMATION

Station Number

P S M 5 5 1 1

Station Horizon Mask

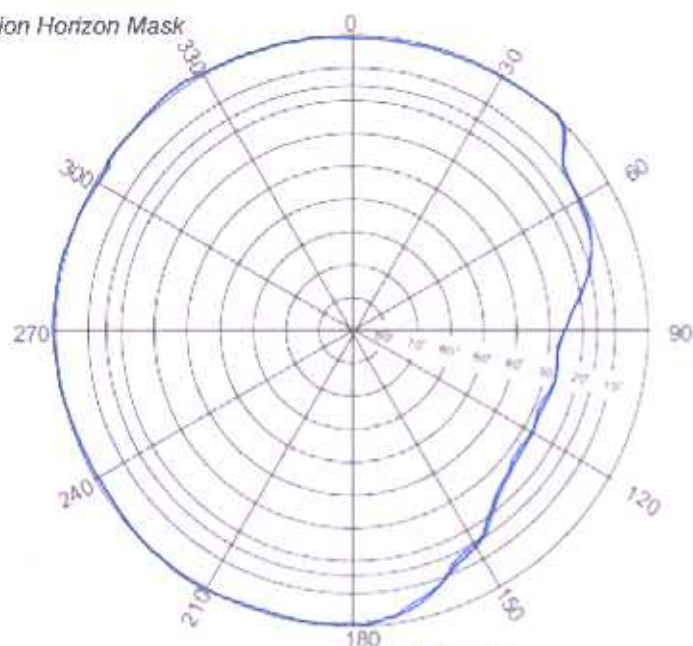

Height above Marker that horizon was mapped from 1.5 m

Magnetic Declination  
Declination applied to this figure?  
☐ Yes ☒ No

Locality

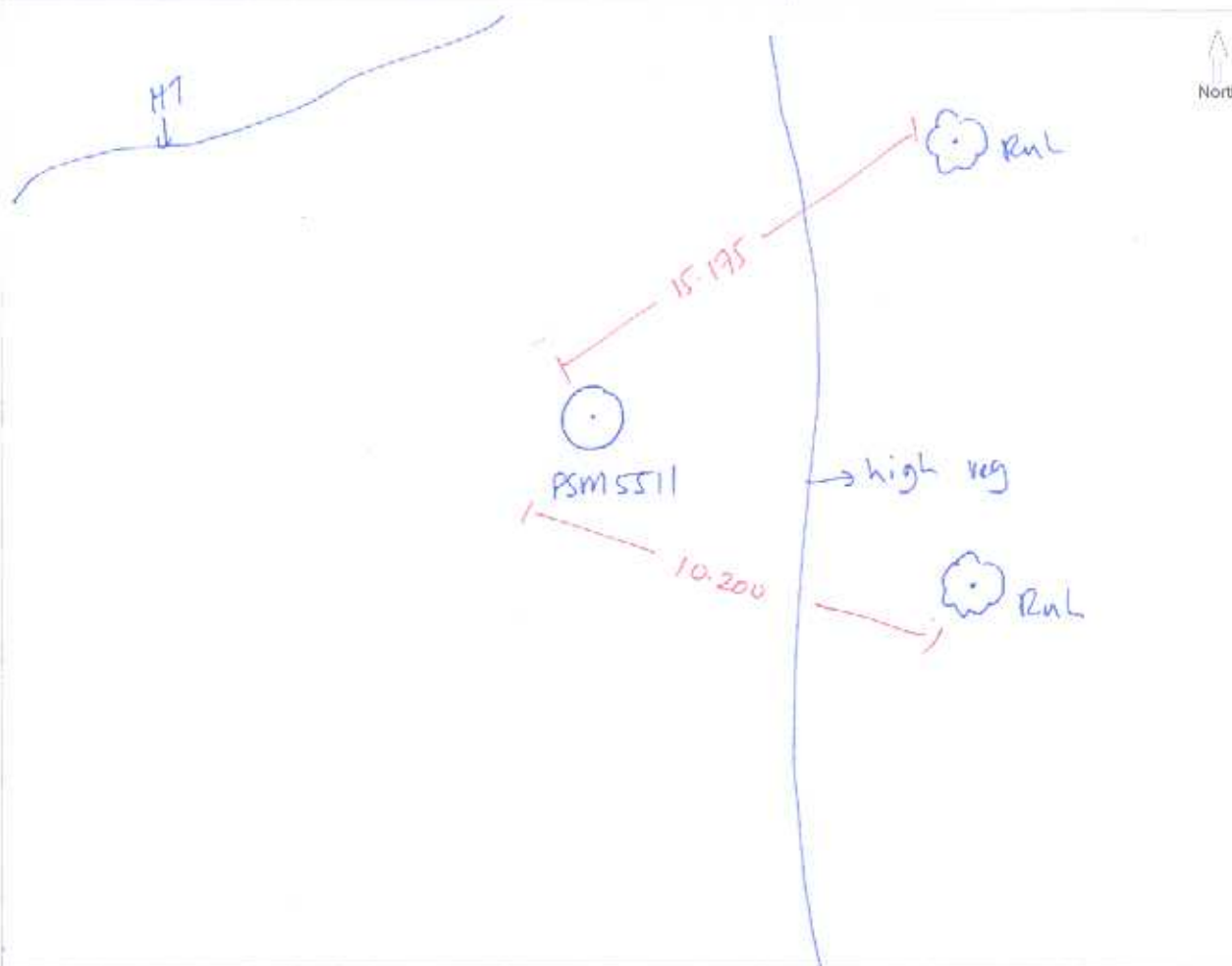

Sketched by: Navaz

Scale: Not to scale

Date: 20 November 2012



**CONTROL POINT DETAILS**

Station Number: **PSM 5512**

**Coordinate Information**

Geodetic

Grid

WGS 84

UTM Zone 43

Lat: 2° 55' 6.5"

E: 264605.207m

Long: 72° 52' 56.4"

N: 322804.325m

Ellp Height: -91.527m

Orth Height: 0.541m

**Island Name: Dhoores**

**Date: 20 June 2012**

*Monument description & method of survey:*

Monument Type A. Point fixed using closed-traverse technique of surveying.  
 Final coordinates derived after traverse adjustment.

*General site conditions & access:*

Point located in open space near low vegetation. Easily accessible.

Owner: Vermillion International Pvt. Ltd.

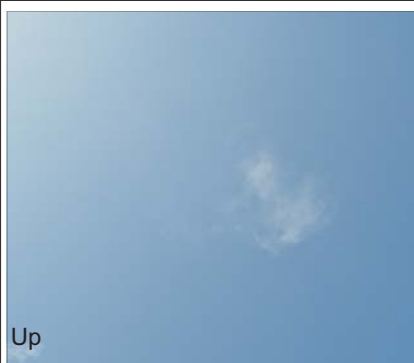



# SITE INFORMATION

Station Number

P S M 5 5 1 2

Station Horizon Mask

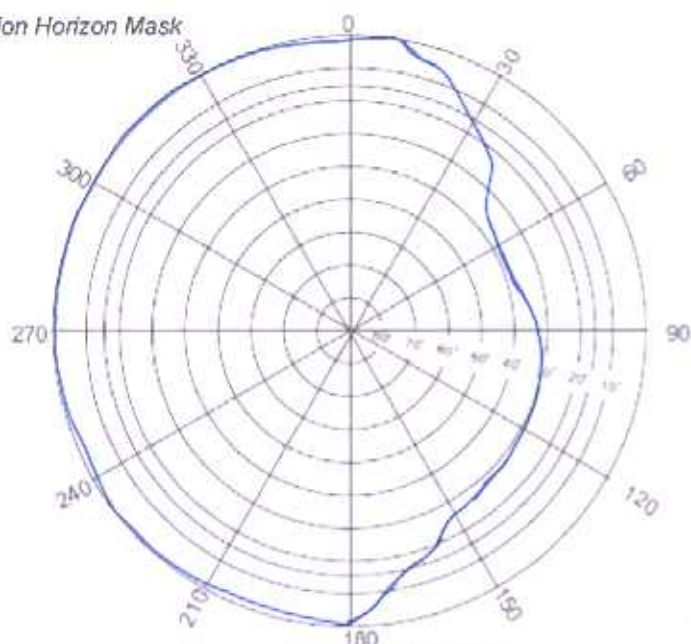

Height above Marker that horizon was mapped from 1.5 m

Magnetic Declination  
Declination applied to this figure?  
☐ Yes ☒ No

Locality

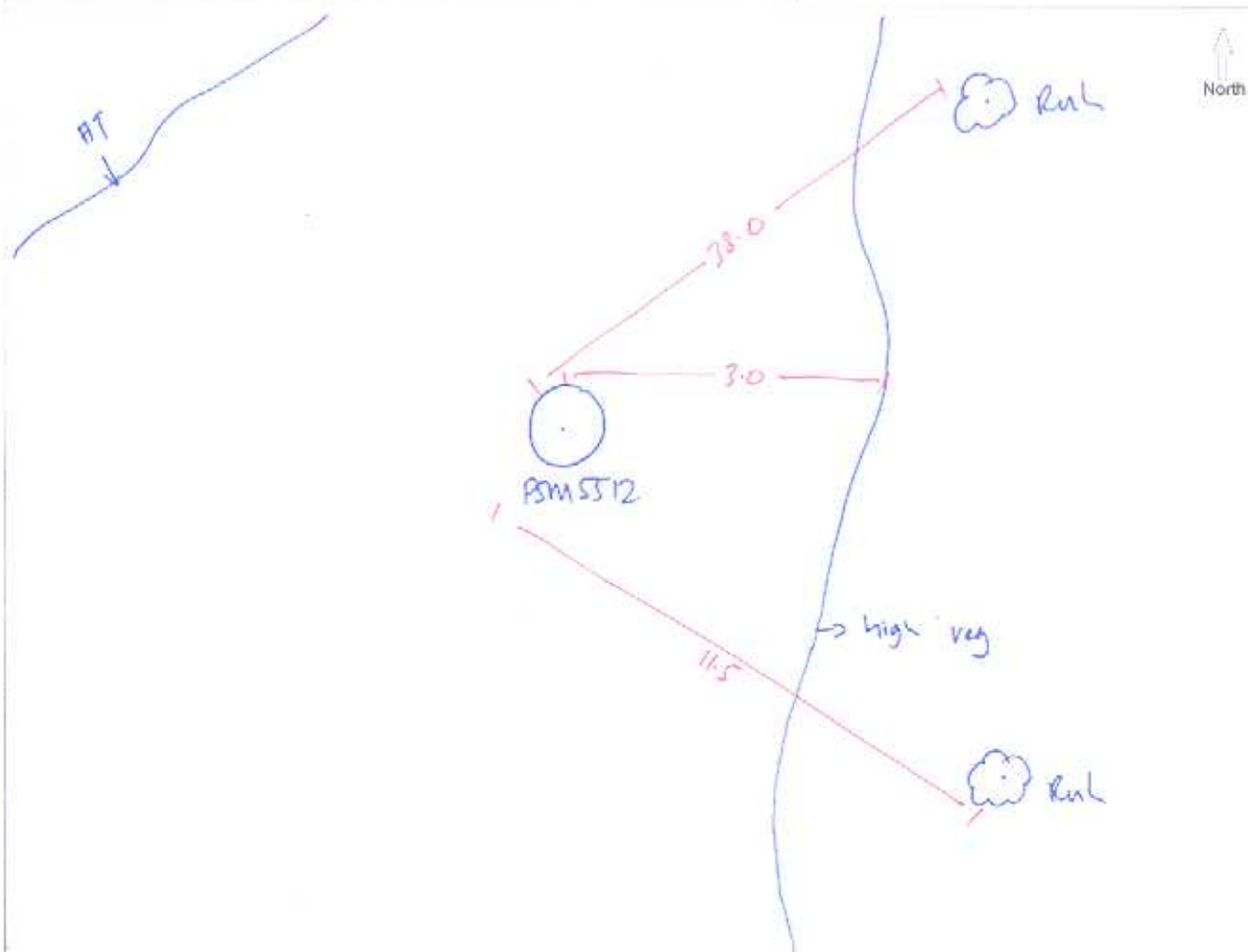
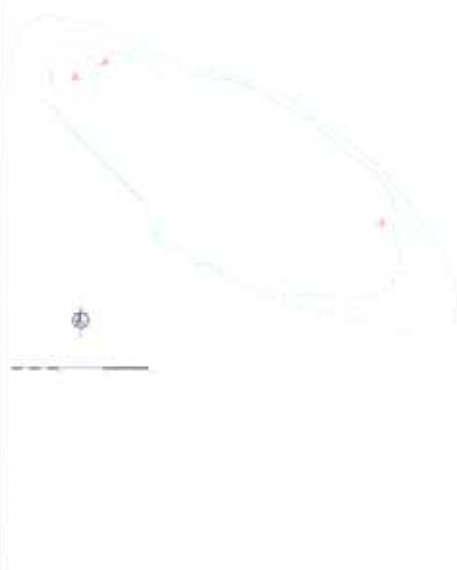

Sketched by: Navaz

Scale: Not to scale

Date: 20 November 2012



**CONTROL POINT DETAILS**

Station Number: **PSM 5513**

**Coordinate Information**

Geodetic

Grid

WGS 84

UTM Zone 43

Lat: 2° 55' 1.3"

E: 264941.659m

Long: 72° 53' 7.3"

N: 322642.792m

Ellp Height: -91.019m

Orth Height: 1.049m

Island Name: **Dhoores**

Date: **20 June 2012**

*Monument description & method of survey:*

Monument Type A. Point fixed using closed-traverse technique of surveying.  
 Final coordinates derived after traverse adjustment.

*General site conditions & access:*

Point located under vegetation. Easily accessible.

Owner: Vermillion International Pvt. Ltd.



# SITE INFORMATION

Station Number

P S M 5 5 1 3

Station Horizon Mask

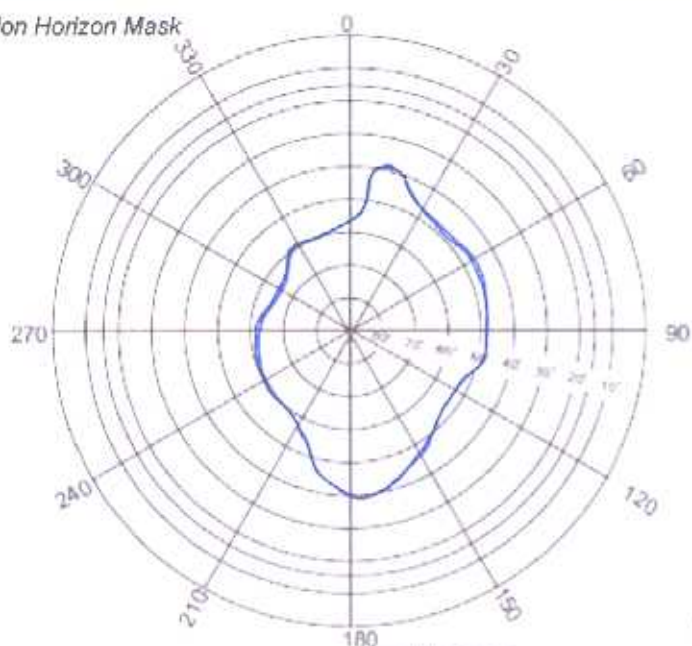

Height above Marker that horizon was mapped from 1.5 m

Magnetic Declination Declination applied to this figure? ☐ Yes ☒ No

Locality



North

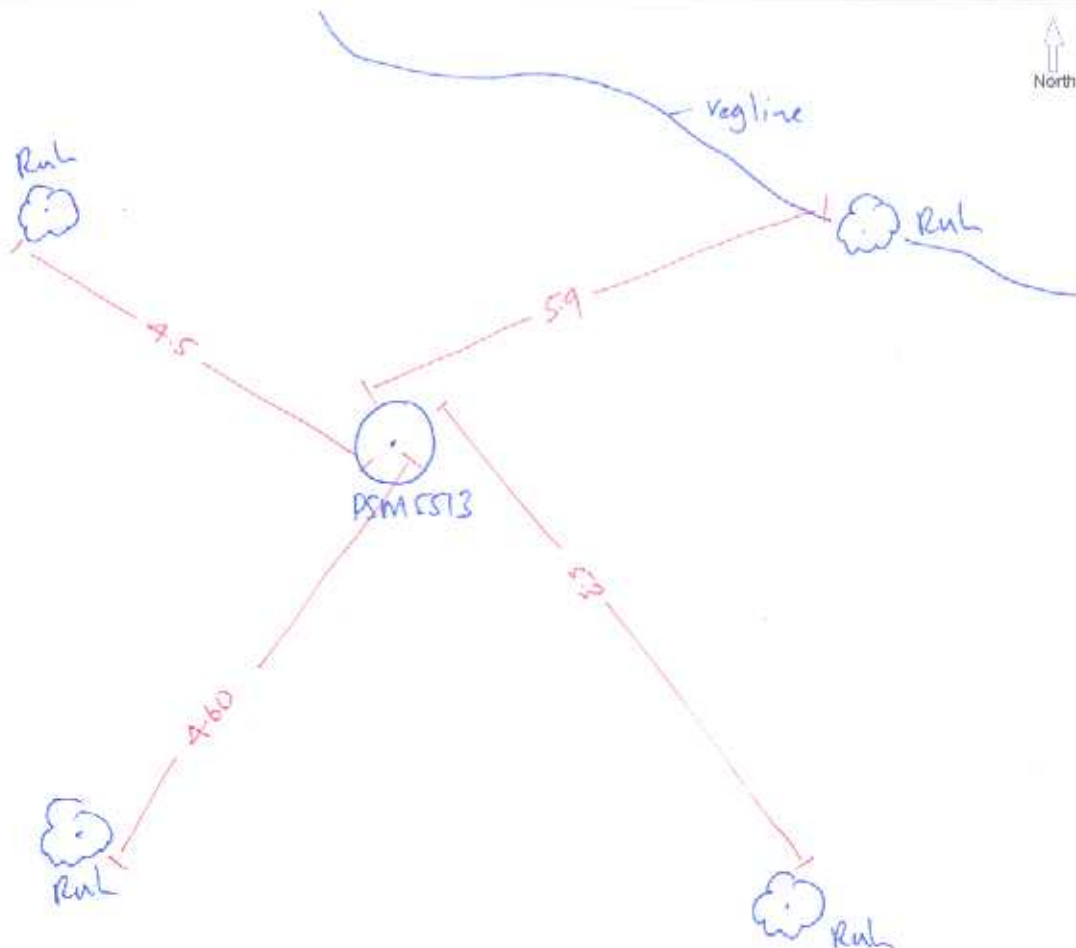

Sketched by: Navaz

Scale: Not to scale

Date: 20 November 2012

MALDIVES LAND AND SURVEY AUTHORITY, MINISTRY OF HOUSING AND INFRASTRUCTURE, Ameerlee Magu, Maafannu, Male', 20392, Maldives, Office (PABX): +(960) 3004300, Fax: +(960) 3004254, Email: [survey@mhe.gov.mv](mailto:survey@mhe.gov.mv), Web: [www.surveyofmaldives.gov.mv](http://www.surveyofmaldives.gov.mv), [www.mhe.gov.mv](http://www.mhe.gov.mv)